

EcoMelt® Melting Furnace

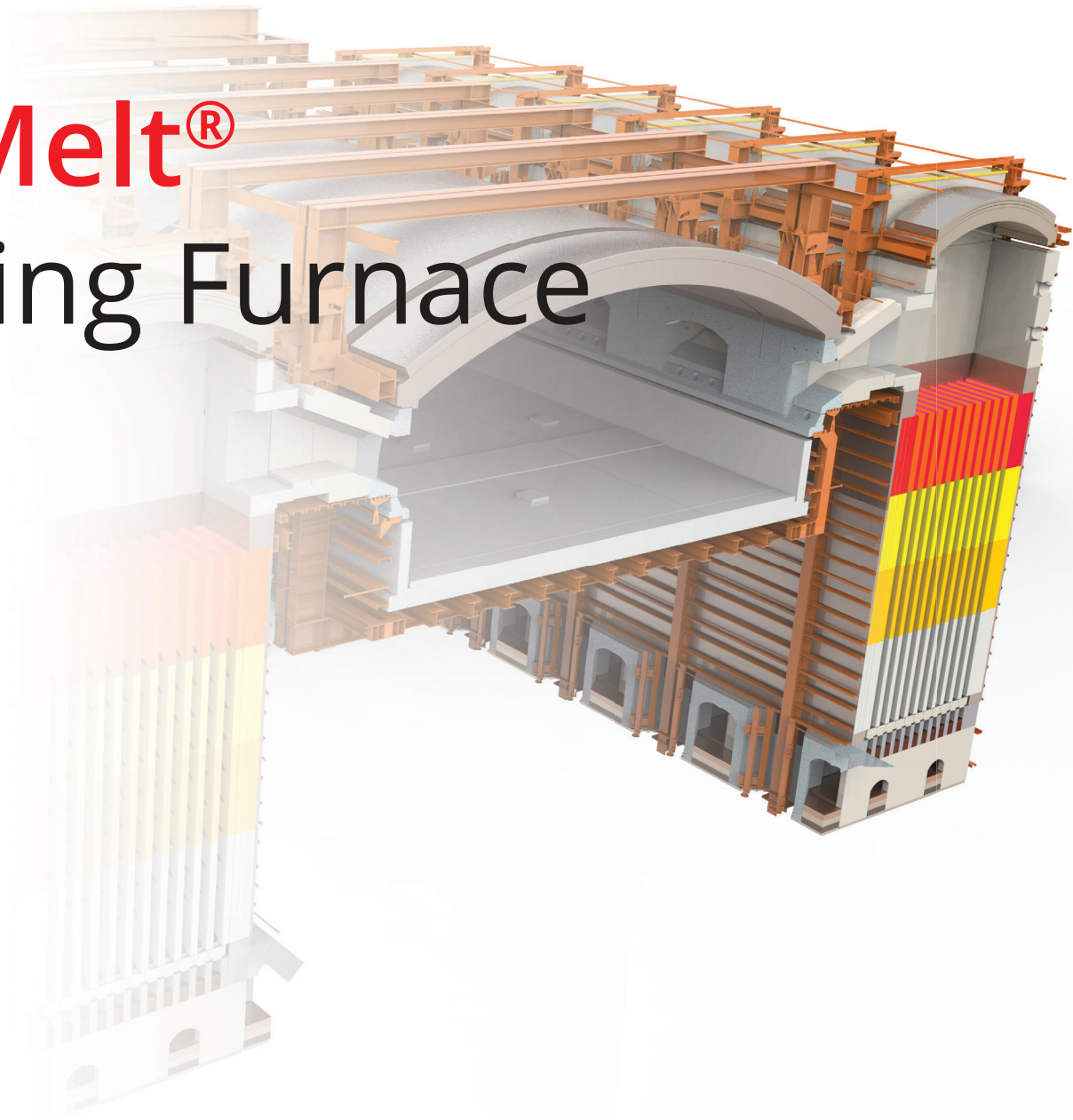

Energy Efficient Regenerative Melting Furnace



The fully customizable EcoMelt® Energy Efficient Furnace is designed to produce the highest quality automotive, solar, and architectural glass, all while maximizing thermal efficiency, minimizing emissions, and extending furnace lifespan. Stewart Engineers works closely with clients to customize glass tonnage, fuel sources, tints, and automation levels, ensuring their specific market requirements are met with precision.



EcoMelt[®] Energy Efficient Melting Furnace



EcoMelt[®] Features

Energy Efficient

Process Design Modeling

Operational Modeling

Automation Features:

- Integrated Control System
- Cascaded Port Firing Control
- Excess O₂ Sensing
- Laser Glass Level Control

Furnace Capacity

- 250 to 1200 MTPD

Over 20 Years of Furnace Longevity

Proven Technology

Superior Optical Quality

Comprehensive Glass Formulations:

- Soda Lime
- Ultra-Clear
- Tints
- Borosilicate

Installation Supervision

Production and Operation Support

Available EcoMelt[®] Furnaces

Type	Soda Lime, Ultra-Clear, Tints, Borosilicate
Tonnage	250 - 1200 MTPD
Energy Efficiency	1350 ± 10% KCAL/KG

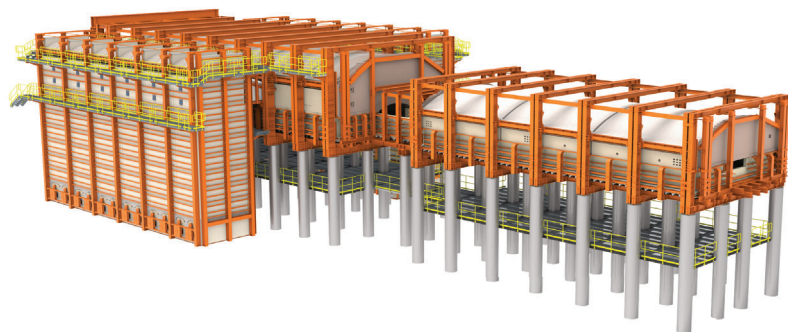

For every project, Stewart collaborates closely with customers to determine the ideal tonnage, ribbon width, and sourcing to meet their unique needs.

Our extensive expertise in glass manufacturing, combined with a strong commitment to innovation, enables us to consistently deliver exceptional products and services to the glass industry.

Engineered and designed to maximize energy efficiency